

High Voltage Rectifier Stacks

0.5A - 2.2A • 3000ns • Axial Leaded

ELECTRICAL CHARACTERISTICS AND MAXIMUM RATINGS											
Part Number	Working Reverse Voltage (Vrwm)	Average Rectified Current (in oil) (Io)		Reverse Current @ Vrwm (Ir)		Forward Voltage (Vf)		1 Cycle Surge Current tp=8.3ms (Ifsm)	Repetitive Surge Current (Ifrm)	Reverse Recovery Time (1) (Trr)	Case Length (L) in.
		55°C	100°C	25°C	100°C	25°C		25°C	25°C	25°C	
	Volts	Amps	Amps	µA	µA	Volts	Amps	Amps	Amps	ns	
SP50S	5000	0.5	0.33	1.0	25	8.5	1.0	40	8	3000	1.125
SP75S	7500	0.5	0.33	1.0	25	17.0	1.0	40	8	3000	1.625
SP100S	10000	0.5	0.33	1.0	25	17.0	1.0	40	8	3000	2.000
SP125S	12500	0.5	0.33	1.0	25	25.5	1.0	40	8	3000	2.375
SP150S	15000	0.5	0.33	1.0	25	25.5	1.0	40	8	3000	2.750
SP200S	20000	0.5	0.33	1.0	25	34.0	1.0	40	8	3000	3.500
SP250S	25000	0.5	0.33	1.0	25	42.5	1.0	40	8	3000	4.250
SP300S	30000	0.5	0.33	1.0	25	51.0	1.0	40	8	3000	5.000
FP25S	2500	2.2	1.30	2.0	50	5.5	4.0	120	20	3000	1.500
FP50S	5000	2.2	1.30	2.0	50	11.0	4.0	120	20	3000	2.500
FP75S	7500	2.2	1.30	2.0	50	16.5	4.0	120	20	3000	3.500
FP100S	10000	2.2	1.30	2.0	50	22.0	4.0	120	20	3000	4.500
FP125S	12500	2.2	1.30	2.0	50	27.5	4.0	120	20	3000	5.500
FP150S	15000	2.2	1.30	2.0	50	33.0	4.0	120	20	3000	6.500
FP175S	17500	2.2	1.30	2.0	50	38.5	4.0	120	20	3000	6.500
FP200S	20000	2.2	1.30	2.0	50	44.0	4.0	120	20	3000	6.500

(1)Trr Testing: If=0.5mA, Ir=1.0A, Irr=0.25A *Op. Temp.= -55°C to +150°C Stg. Temp.= -55°C to +150°C

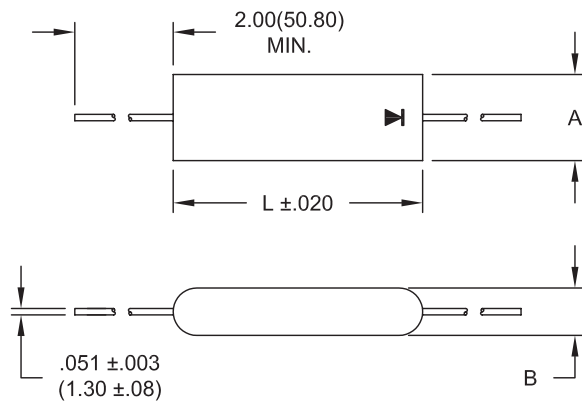

Part	A	B
SP(XXXX)	.500 ±.020 (12.70 ±.51)	.250 ±.020 (6.35 ±.51)
FP(XXXX)	.690 ±.020 (17.53 ±.51)	.380 ±.020 (9.65 ±.51)

Dimensions: In. (mm) • All temperatures are ambient unless otherwise noted. • Data subject to change without notice.



Voltage Multipliers Inc.

8711 W. Roosevelt Ave.
Visalia, CA 93291 USA

Tel: 559.651.1402
Fax: 559.651.0740

www.voltagemultipliers.com
www.highvoltagepowersupplies.com