

High Voltage Diodes - Surface Mount

150mA - 500mA • 70ns

ELECTRICAL CHARACTERISTICS AND MAXIMUM RATINGS

Part Number	Working Reverse Voltage (V _{rwm})	Average Rectified Current (I _o)		Reverse Current @ V _{rwm} (I _r)		Forward Voltage (V _f)		1 Cycle Surge Current t _p =8.3ms (I _{fsm})	Repetitive Surge Current (I _{frm})	Reverse Recovery Time (3) (T _{rr})	Thermal Impd. θ _{J-L}	Junction Cap. @50VDC @1kHz (C _j)	Markings
		55°C(1)	100°C(2)	25°C	100°C	25°C	25°C						
		Volts	mA	mA	µA	µA	Volts						
SXF6521	2000	500	250	0.5	20	3.0	500	25	5	70	7.0	8.0	6521
SXF6523	3000	250	125	0.5	20	5.0	250	15	3	70	7.0	4.0	6523
SXF6525	5000	150	75	0.5	20	7.0	150	10	2	70	7.0	3.0	6525

(1)TC=55°C (2)TC=100°C (3)I_f=125mA, I_r=250mA, I_{rr}=63mA *Op. Temp.= -65°C to +175°C Stg. Temp.= -65°C to +200°C



Part	A	B	C
SXF6521	.240 ±.010 (6.10 ±.25)	.200 ±.005 (5.08 ±.13)	.130 (3.30)
SXF6523	.280 ±.010 (7.11 ±.25)	.240 ±.005 (6.10 ±.13)	.170 (4.32)
SXF6525			

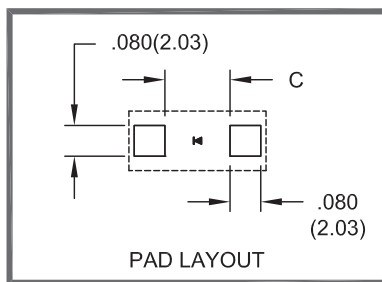

Tolerance:
.XXX ±.005

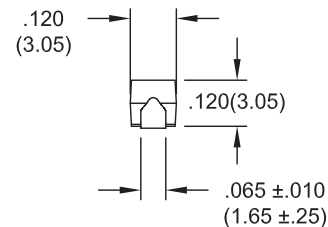
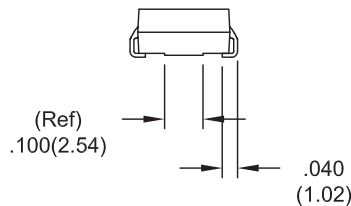
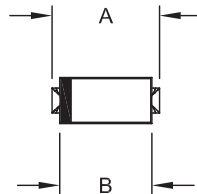

Dimensions: In. (mm) • All temperatures are ambient unless otherwise noted. • Data subject to change without notice.



Voltage Multipliers Inc.

8711 W. Roosevelt Ave.
Visalia, CA 93291 USA

Tel: 559.651.1402
Fax: 559.651.0740

www.voltagemultipliers.com
www.highvoltagepowersupplies.com

SXF6521 SXF6523 SXF6525

1

